

LEVEL 1

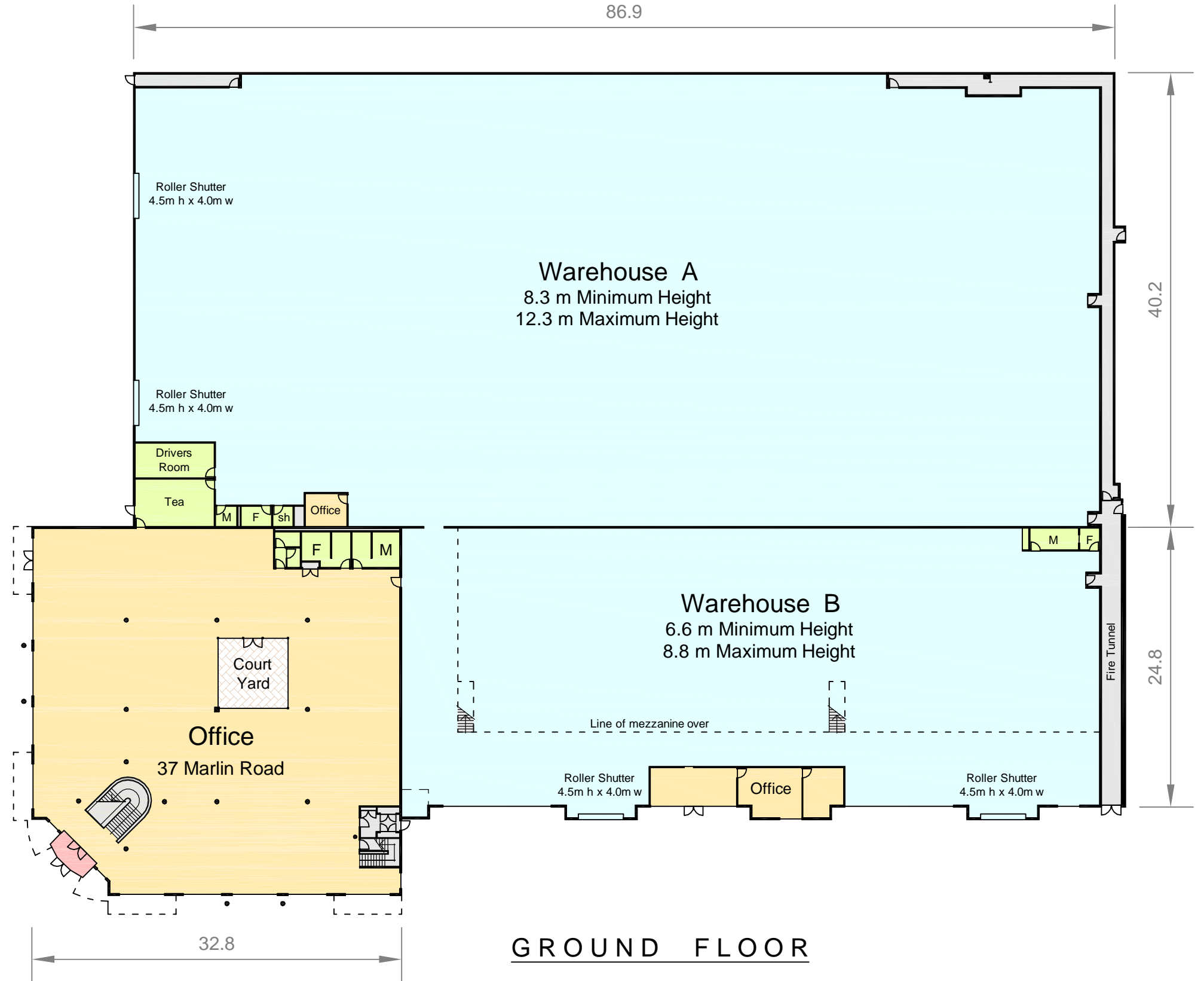

Information Schedule

| | |
|---------------------|---------------------------|
| Warehouse A | 3534 m ² |
| Warehouse B | 1611 m ² |
| Ground Floor Office | 1059 m ² |
| Level 1 Office | 1039 m ² |
| Total Area | 7243 m² |
| Warehouse Mezzanine | 1028 m ² |



GROUND FLOOR



Disclaimer: This plan has been prepared for marketing purposes only. Interested parties should undertake their own enquiries as to the accuracy of the information. Areas are approximate and dimension rounding may result in area discrepancies.

Plan Prepared For:



MARKETING DRAWING
37 Marlin Road
WILLIAMSTOWN, VIC

Date: 04/03/2005

Ref: 23055ML Rev: 0

Scale: 1:400 at A3

Plan Prepared By:



Phone 03 9415 6565

Fax 03 9923 6307

info@realservice.com.au

www.realservice.com.au